

# DP Tools



## DP circular saw blade for multi rip saws

For laminate material

Available at short notice!

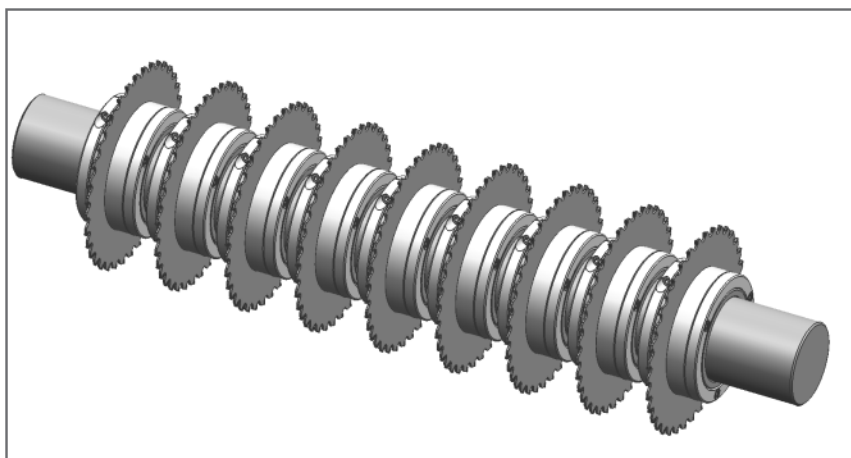

### Choose from our available semi-finished products

D mm	B mm	b mm	d	d max	Z
210	2,20 - 2,40	1,60	30	120	36
210	2,20 - 2,40	1,60	30	120	48
210	2,20 - 2,40	1,60	30	120	54
250	2,20 - 2,40	1,60	30	120	36
250	2,20 - 2,40	1,60	30	120	48
250	2,20 - 2,40	1,60	30	120	54
250	2,80 - 3,30	2,00	30	120	36
250	2,80 - 3,30	2,00	30	120	48
250	2,80 - 3,30	2,00	30	120	54
300	2,80 - 3,30	2,20	30	120	48
300	2,80 - 3,30	2,20	30	120	54

Please indicate the kerf, bore diameter and tooth shape of your required tool in order to determine the design.

#### Tooth shape to your choice:

Flat/ triple-chip tooth (FT)

Flat tooth (F)

Triple-chip tooth (T)

Alternate top bevel tooth (W)

**Optionally:** We offer a suitable coating for your field of application, e.g. PLT- coated (wear- resistant, protection against premature warming) at an extra charge.

***We are pleased to assist you designing the tool.***

## DP universal circular saw blade

Longitudinal and cross cut



**7014/7015**

<b>APPLICATION:</b>	For universal application
<b>MATERIAL:</b>	Wood-based material, raw and one-side coated, paper based laminate, thermoplastic material
<b>MACHINE:</b>	Sizing saw, cross cut saw
<b>DESIGN:</b>	Rigid saw body; • = with copper plugs
<b>TOOTH:</b>	Flat tooth (F) Alternate top bevel tooth (W), DP

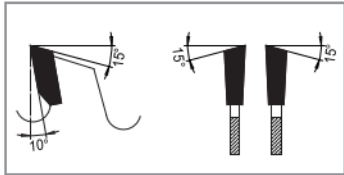

	D mm	B mm	b mm	d mm	NL mm	th mm	Z	DT	Order No.
•	180	3,20	2,20	30		5,0	36F	◇	701518031
•	180	3,20	2,20	30		5,0	36W		701518030
•	180	3,20	2,20	30		5,0	54F	◇	701518036
•	180	3,20	2,20	30		5,0	54W		701518035
•	250	3,20	2,20	30		5,0	48W	◇	701425030
•	250	3,20	2,20	30	NLK	5,0	60W m. Achsw.		7014250007
•	250	3,20	2,20	30		4,0	72W		701525031
•	303	3,20	2,20	30	NLK	5,0	48W	◇	701430325
•	303	3,20	2,20	30	NLK	5,0	60W		701430333
•	303	3,20	2,20	30	NLK	4,0	72W m. Achsw.		701430331
•	303	3,20	2,20	30	NLK	5,0	72W		701430334
•	303	3,20	2,20	30	NLK	4,0	96W m. Achsw.		701530330
•	350	3,50	2,40	30	NLK	4,0	72W		701435031
•	350	3,50	2,40	30	NLK	4,0	108W	◇	701535030

## DP Universal Plus

The improved universal circular saw blade for cross cuts and mitre cuts.



# 7515

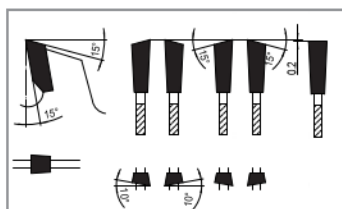

<b>APPLICATION:</b>	Sizing of wood-based material in finish-cut quality
<b>MATERIAL:</b>	Laminated wood-based material including material with very thick top layers, solid wood, plastic profiles, plastic coated ledges.
<b>MACHINE:</b>	Vertical panel sizing saw, sizing saw, CNC resp. machining centres, double mitre saw
<b>DESIGN:</b>	Reduced kerf; low noise due to specific laser ornaments • = with copper plugs
<b>TOOTH:</b>	Alternate top bevel tooth (with axial angle) - Alternate top bevel tooth (with axial angle) - Alternate top bevel tooth (with axial angle) - Alternate top bevel tooth (with axial angle) - flat tooth

	D mm	B mm	b mm	d mm	NL mm	th mm	Z	Order No.
•	303	3,00	2,20	30	NLK	3,50	100	751530330
•	303	3,20	2,20	30	NLK	3,50	100	751530331
•	350	3,20	2,20	30	NLK	3,50	100	751535030

## DP circular saw blade for wood-based material

Sizing. For longest service life



**7021**

<b>APPLICATION:</b>	Longitudinal and cross-cut
<b>MATERIAL:</b>	Wood-based material, raw and coated, Duroplast
<b>MACHINE:</b>	Panel sizing unit with scoring aggregate
<b>DESIGN:</b>	Rigid saw body; • = with copper plugs
<b>TOOTH:</b>	Triple-chip flat tooth (FT), with protective chamfer on both sides, DP

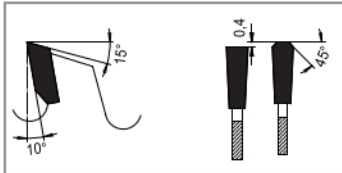

	D mm	B mm	b mm	d mm	NLK mm	th mm	Z	Order No.
•	250	3,20	2,20	30	NLK	5,0	48FT	702125030
•	250	3,20	2,20	30	NLK	5,0	60FT	702125031
•	300	3,20	2,20	30	NLK	4,0	96FT	702130030
•	303	3,20	2,20	30	NLK	5,0	48FT	702130325
•	303	3,20	2,20	30	NLK	5,0	60FT	702130331
•	303	3,20	2,20	30	NLK	5,0	72FT	702130438
•	350	3,50	2,40	30	NLK	4,0	96FT	702135030

## DP circular panel sizing saw blade

For longest service life



### 7024

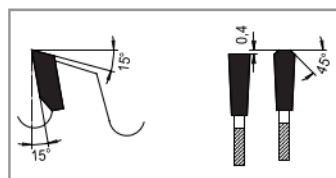

<b>APPLICATION:</b>	Panel sizing, single and in packs
<b>MATERIAL:</b>	Wood-based material, laminated, Duroplast
<b>MACHINE:</b>	Panel sizing unit, horizontal, with scoring aggregate
<b>DESIGN:</b>	Rigid saw body; • = with copper plugs
<b>TOOTH:</b>	Flat / triple-chip tooth (FT), DP

	D mm	B mm	b mm	d mm	NL mm	Machine	th mm	Z	DT	Order No.
•	305	4,40	3,00	30			5,0	60FT		702430537
•	350	4,40	3,00	30	2/10/60	Mayer, Schelling	5,0	72FT		702435005
•	350	4,40	3,20	30			5,0	84FT		702435030
•	380	4,40	3,20	30			5,0	72FT		702438030
•	380	4,40	3,20	60	2/14/100	Homag / Holzma	5,0	72FT		702438013
•	380	4,80	3,50	60	2/14/100	Homag / Holzma	5,0	72FT		702438066
•	400	4,40	3,20	30			5,0	72FT		702440008
•	430	4,40	3,20	80	2/9/130 4/19/120	Biesse / Selco	5,0	72FT		702443005
•	450	4,80	3,50	30			5,0	72FT		702445030
•	450	4,80	3,50	60	2/14/125 2/19/120	Homag / Holzma	5,0	72FT		702445062
•	480	4,80	3,50	60	2/11/115 2/19/120	Homag / Holzma	5,0	72FT		712448060
•	500	4,80	3,50	30			5,0	72FT		702450030
•	600	5,80	4,00	60	2/11/115 2/19/120	Homag / Holzma	6,5	60FT		702460060
•	620	6,20	4,00	40	2/13/114 2/13/140	Schelling	6,5	60FT		702462040
•	680	5,80	4,00	40	2/13/114 2/13/140	Schelling	6,5	60FT	◇	702468042
•	680	6,20	4,00	40	2/13/114 2/13/140	Schelling	6,5	60FT		702468041

## DP circular scoring saw blade

Scoring of wood-based material. For longest service life



**7026**

<b>APPLICATION:</b>	Scoring of coated wood-based material, parallel feed, bottom up
<b>MATERIAL:</b>	Plastic laminated and film-coated wood-based material
<b>MACHINE:</b>	Panel sizing unit with scoring aggregate, trimming saw with scoring aggregate
<b>DESIGN:</b>	Conical flat tooth DP, for high feed rates and long service life; • = with copper plugs
<b>TOOTH:</b>	Flat tooth (F) conical, alternate top bevel tooth (W) conical, DP

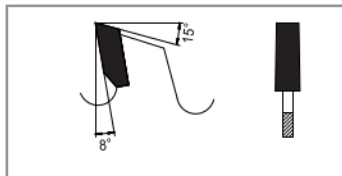

	D mm	B mm	b mm	d mm	NL mm	Machine	th mm	Z	Order No.
	80	2,8-3,6	4,00	20		Felder, Striebig	5,0	10F+10F	702608020
	120	2,8-3,6	4,00	20		Holzher, SCM	5,0	12F+12F	702612020
	120	2,8-3,8	4,00	22		Altendorf	5,0	12F+12F	702612002
	120	2,8-3,6	4,40	50		Altendorf	5,0	12F+12F	702612050
	125	2,8-3,6	4,00	20		Paoloni	5,0	12F+12F	702612523
	125	3,1-3,9	2,20	20		Panhans	5,0	24F kon.	702612525
•	125	4,4-5,2	3,40	20		Giben, Gabbiani, Panhans	5,0	24F kon.	702612521
NEW	127	4,4-5,2	3,40	45		Giben	5,0	24F kon.	702612701
NEW	150	3,3-4,1	2,20	45		Homag / Holzma 130	5,0	28F kon.	702615045
NEW	150	3,7-4,5	2,80	30		Mayer PS 80	5,0	28F kon.	702615030
	150	4,4-5,2	3,20	30		Homag / Holzma 130	5,0	28F kon.	702615001
NEW •	150	4,4-5,2	3,20	30		Mayer	5,0	28F kon.	702615013
NEW	180	3,3-4,1	2,20	30	NLK	Panhans Eco	5,0	28F kon.	702618030
NEW	180	3,7-4,5	2,80	45		Homag / Holzma HP/HKL 300	5,0	36F kon.	702618145
•	180	4,4-5,2	3,20	20		Anthon, Panhans Schelling	5,0	32W kon.	702618021
NEW •	180	4,4-5,2	3,20	30	NLK	Panhans	5,0	28F kon.	702618017
•	180	4,4-5,2	3,20	45		Homag / Holzma	5,0	32F kon.	702618044
•	180	4,8-5,6	3,50	45		Homag / Holzma	5,0	32F kon.	702618046
NEW	190	3,7-4,5	2,80	50	2/7/80	Giben	5,0	32F kon.	702619050
NEW	200	3,3-4,1	2,20	45		Homag / Holzma 230	5,0	36F kon.	702620045
NEW	200	3,7-4,5	2,80	20	2/11/66	Schelling FH4, Panhans	5,0	36F kon.	702620021
NEW	200	3,7-4,5	2,80	65	2/9/100 2/9/110	Biesse / Selco	5,0	32F kon.	702620165
NEW •	200	4,4-5,2	3,20	80	2/14/110	Gabbiani, SCM	5,0	32F kon.	702620083
•	200	4,4-5,2	3,40	20	2/11/66	Schelling	5,0	24F kon.	702620024
•	200	4,4-5,2	3,40	20	2/11/66	Schelling	5,0	32F kon.	702620020
NEW	200	4,4-5,2	3,50	30	2/8,5/60	Scheer	5,0	36F kon.	702620026
NEW •	200	4,4-5,2	3,50	45		Homag / Holzma 200	5,0	32F kon.	7026200706
•	200	4,4-5,2	3,50	65	2/9/100 2/9/110	Biesse / Selco	5,0	32F kon.	702620067
•	200	4,8-5,6	3,50	45		Homag / Holzma	5,0	32F kon.	702620046
•	200	4,8-5,6	3,50	65	2/9/100 2/9/110	Biesse / Selco	5,0	32F kon.	702620068
•	200	5,8-6,6	4,50	45		Homag / Holzma	5,0	32F kon.	702620047

## SuperSilent

### The Glory of Silence



## HEARING

If the noise level is reduced by 20 dB this means that the volume will go down by 75%, the sound pressure even by 90% and the sound intensity by 99%.

With idle running and no disturbing periphery a level of less than 75 dB(A) can be achieved.



## FEELING

New standards in terms of safety at work thanks to patented MicroGeo® technology:

There is hardly any cutting pressure: "You are sawing as if through butter".

Almost no rebound during work, flying material parts are a thing of the past.

Effortless sawing of extremely thin ledges.

Despite the very sharp cut hardly any danger of injury when handling the tool.



## SEEING

The *SuperSilent* is THE universal tool that lives up to its name.

It cuts simply all wood-based material such as chip board, MDF or plywood continuously. Even so, if coated on both sides.

Especially planed dry solid wood can be processed in unprecedented quality with longitudinal cuts and cross cuts.

Even abrasive material such as laminate does not pose any obstacle for this tool.



## MARVELING

The high-quality diamond cutting material ensures a long tool life and excellent cutting results – at remarkably low costs per cut.



Moreover, down-times for laborious tool changes and investing in a full range of circular saw blades is no longer necessary.

Even tedious fine adjustments of the scoring blades are a thing of the past.



## The SuperSilent versions by comparison

„Select“ & „Universal“

<i>The SuperSilent versions by comparison</i>		
<i>Performance with ...</i>	 <i>SuperSilent 2 „Select“</i>	 <i>SuperSilent 3 „Universal“</i>
Sizing of large panels	○	++
Processing high-strain types of material	○	++
Finish cut quality*	++	++
Planing cut quality**	+++	+
Mitre cuts	++	++
<i>Others ...</i>	<i>SuperSilent 2 „Select“</i>	<i>SuperSilent 3 „Universal“</i>
Regular sharpening cycles	1x	2x
Noise generation***	+++	+++
Material savings***	+++	++
Machine precision requirements	heightened	normal
Accuracy requirements in action	heightened	normal

\* Depending on the material possibly with scorer

\*\* requires a low-vibration and serviced machine and peripheral equipment

\*\*\* Compared to standard circular saw blades

## SuperSilent 2 „Select“

For precise cuts in low-strain types of material.

Planing cut quality possible. Extremely high material savings.

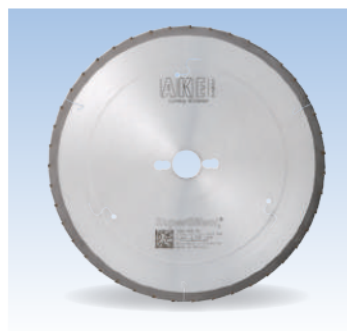

7821

<b>APPLICATION:</b>	Longitudinal cut, cross cut, planing cut
<b>MATERIAL:</b>	Wood-based material raw and coated, planed dry solid wood
<b>MACHINE:</b>	Sizing circular saws with scoring aggregate
<b>DESIGN:</b>	ChipBelt®, safe@work®, low noise, reduced cutting pressure
<b>TOOTH:</b>	MicroGeo®, Direct-Chip-Guide®-Design, DP

### Main saw blade

D mm	B mm	b mm	d mm	NL mm	Z	Order No.
303	2,00	1,80	30	2/7/42 + 2/9/46,5 + 2/10/60	43	7821.303.30

### Your advantages with SuperSilent 2.

- Universal: processing of wood and wood-based materials
- Brilliant cutting result
- Planing cut quality with solid wood
- 75% quieter than standard circular saw blades
- Extremely economical by means of 1 time re-sharpening
- Maximum material utilisation due to 2,0 mm kerf

## SuperSilent 3 „Universal“

For first-class cutting results even in high-strain types of material.  
Particularly suitable for sizing large panels.



7821

<b>APPLICATION:</b>	Longitudinal cut, cross cut, planing cut
<b>MATERIAL:</b>	Wood-based material raw and coated, planed dry solid wood
<b>MACHINE:</b>	Sizing circular saws with scoring aggregate
<b>DESIGN:</b>	ChipBelt®, safe@work®, low-noise, reduced cutting pressure
<b>TOOTH:</b>	MicroGeo®, Direct-Chip-Guide®-Design, DP

### Main saw blade

D mm	B mm	b mm	d mm	NL mm	Z	Order No.
300	2,40	1,80	30	2/7/42 + 2/9/46,5 + 2/10/60	43	7821.300.43.30-B24
350	2,60	2,00	30	2/7/42 + 2/9/46,5 + 2/10/60	53	7821.350.53.30-B26

### Your advantages with SuperSilent 3.

- Universal: processing of wood and wood-based materials
- Sizing of large panels much easier
- Improved processing of high-strain types of material
- Well-known brilliant cutting quality
- Incredibly economical: 2 times re-sharpenable
- Advanced tooth geometry
- 75% quieter than standard circular saw blades
- Comfortable: Lower requirement on machine alignment

## SuperSilent

For vertical panel sizing machines

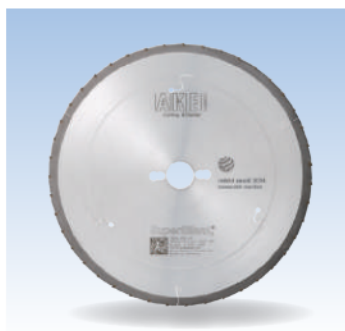

7825

<b>APPLICATION:</b>	Longitudinal cut, cross cut
<b>MATERIAL:</b>	Wood-based material raw and coated, planed dry solid wood
<b>MACHINE:</b>	Vertical panel sizing machines
<b>DESIGN:</b>	ChipBelt®, safe@work®, low noise, reduced cutting pressure
<b>TOOTH:</b>	MicroGeo®, Direct-Chip-Guide®-Design, DP

D mm	B mm	b mm	d mm	NL mm	Z	Order No.
303	2,40	1,80	30	2/7/42 + 2/9/46,5 + 2/10/60	43	7825.303.43.30

### Your advantages with *SuperSilent* for vertical panel sizing machines.

- Optimised especially for vertical panel sizing machines
- Brilliant cutting result
- 75% quieter than standard circular saw blades
- Universal: processing of wood and wood-based materials
- Suitable for sizing large panels
- Cutting result without any burning marks possible – even with larger cutting heights
- Can optionally be combined with SuperSilent scoring blade
- Extremely efficient: 2 times re-sharpenable, thus long tool life
- Incredibly favourable operating costs

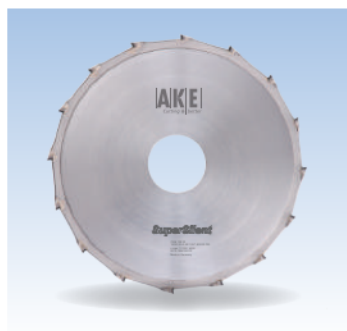

**7826**

1-piece scorer. Conical ATB tooth with MicroGeo®-design.  
Same functional principle as with a *SuperSilent* main saw blade.

### For *SuperSilent 2* - „Select“

D mm	B mm	B <sub>2</sub> mm	b mm	d mm	Machine	Z	Order No.
80	2,00	2,40	1,80	20	Felder	12	7826.080.12.20-B24
100	2,00	2,40	1,80	20	Martin, Panhans, Schelling	16	7826.100.16.20-B24
100	2,00	2,40	1,80	22	Altendorf, Panhans, Robland, SCM	16	7826.100.16.22-B24
120	2,00	2,40	1,80	20	Holz-Her, SCM, MAKA	20	7826.120.20.20-B24
120	2,00	2,40	1,80	22	Altendorf, Martin	20	7826.120.20.22-B24
125	2,00	2,40	1,80	20	Panhans, Paoloni	20	7826.125.20.20-B24
125	2,00	2,40	1,80	22	Altendorf, Martin	20	7826.125.20.22-B24

### For *SuperSilent 3* - „Universal“ and

### For *SuperSilent Type 7825*

D mm	B mm	B <sub>2</sub> mm	b mm	d mm	Machine	Z	Order No.
80	2,40	2,80	1,80	20	Felder	12	7826.080.12.20-B28
100	2,40	2,80	1,80	20	Martin, Panhans, Schelling	16	7826.100.16.20-B28
100	2,40	2,80	1,80	22	Altendorf, Panhans, Robland, SCM	16	7826.100.16.22-B28
120	2,40	2,80	1,80	20	Holz-Her, SCM, MAKA	20	7826.120.20.20-B28
120	2,40	2,80	1,80	22	Altendorf, Martin	20	7826.120.20.22-B28
125	2,40	2,80	1,80	20	Panhans, Paoloni	20	7826.125.20.20-B28
125	2,40	2,80	1,80	22	Altendorf, Martin	20	7826.125.20.22-B28



**Please Note:** Everything about *SuperSilent*, e.g. explanations concerning the functional principal, our FAQ or the suitable accessories (such as riving knife, spacer or reducing ring) is available under: [www.ake.de](http://www.ake.de).

Our topical *SuperSilent*-further developments as well as the current brochures are available for download as well.

## DP spare circular saw blade for hoggers

Suitable for saw blade segment hoggers



**7032**

<b>APPLICATION:</b>	For sizing wood-based material with scoring aggregate hogging and double-hogging.
<b>MATERIAL:</b>	Wood-based material, raw and coated
<b>MACHINE:</b>	Double-end tenoner, edge bander
<b>DESIGN:</b>	DP saw blade (flat tooth); with axial angle for improved chip removal.
<b>TOOTH:</b>	Flat tooth (F) with axial angle, DP

### Segment hogger Type 0033



D mm	B mm	b mm	d mm	NL mm	rhs/ lhs	th mm	Z	DT	Order No.
250	4,00	2,80	80	6/10/200	lhs	5,0	36F		703225007
250	4,00	2,80	80	6/10/200	rhs	5,0	36F		703225008
250	4,00	2,80	80	6/10/200	lhs	5,0	48F		703225009
250	4,00	2,80	80	6/10/200	rhs	5,0	48F		703225011
250	4,00	2,80	80	6/10/200	lhs	5,0	60F	◇	703225021
250	4,00	2,80	80	6/10/200	rhs	5,0	60F	◇	703225022
250	4,00	2,80	80	6/10/200	lhs	5,0	72F	◇	703225023
250	4,00	2,80	80	6/10/200	rhs	5,0	72F	◇	703225024

## DP spare circular saw blade for hogger

Suitable for vario hogger



**7032/7033**

Vario hogger  
Type 7033



<b>APPLICATION:</b>	For sizing wood-based material. Hogging of residual timber on multi-rip saw without flange sleeve.
<b>MATERIAL:</b>	Panel material raw and coated
<b>MACHINE:</b>	Double-end profiler, multi-rip saw
<b>DESIGN:</b>	DP saw blade (flat tooth) with axial angle, for improved chip removal.
<b>TOOTH:</b>	Flat tooth (F) with axial angle, DP

D mm	B mm	b mm	d mm	rhs/lhs	th mm	Z	Order No.
250	5,50	5,00	80	lhs	5,0	12F	703325081
250	5,50	5,00	80	rhs	5,0	12F	703325082
255	6,00	5,00	80	lhs	5,0	12 / 6F	703325583
255	6,00	5,00	80	rhs	5,0	12 / 6F	703325584
255	4,30	2,80	80	lhs	5,0	36F	703225587
255	4,30	2,80	80	rhs	5,0	36F	703225586
255	4,30	2,80	80	lhs	5,0	48F	703225581
255	4,30	2,80	80	rhs	5,0	48F	703225582
255	4,30	2,80	80	lhs	5,0	60F	703225583
255	4,30	2,80	80	rhs	5,0	60F	703225584
260	5,00	4,00	80	lhs	5,0	12 / 6F	703326085
260	5,00	4,00	80	rhs	5,0	12 / 6F	703326086

## DP shank cutter - *blackline*

Z1, with DP boring tip

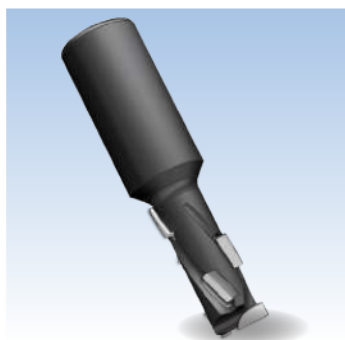

**43020**

**APPLICATION:**

For sizing, grooving, jointing, rebating.  
To be applied with collet chuck.

**MATERIAL:**

Panel material with and without coating.  
Thermosetting plastic.

**MACHINE:**

Stationary machines with and without tool changer

**DESIGN:**

DP knives with axial angle and divided cut;  
shank 16 and 25 with internal thread.

**TOOTH:**

DP, Ø 8- 12 mm 2,5 mm; from Ø 16 mm tip height 3 mm

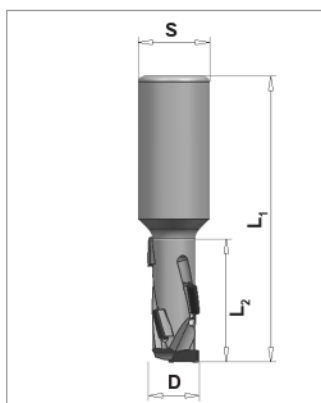

D mm	L2 mm	L1 mm	Shank mm	Z	rhs/lhs	Order No.
8	25	70	12	1+1	rhs	10182747
8	25	70	12	1+1	lhs	10182748
10	25	70	12	1+1	rhs	10182749
12	28	75	12	1+1	rhs	10182646
12	28	75	12	1+1	lhs	10182750
16	28	90	16	1+1	rhs	10182751
16	28	90	16	1+1	lhs	10182752
16	34	95	16	1+1	lhs	10182753
16	34	95	16	1+1	rhs	10182647
18	28	90	25	1+1	rhs	10182754
18	28	90	25	1+1	lhs	10182755
18	34	95	25	1+1	rhs	10182756
18	34	95	25	1+1	lhs	10182757
18	43	100	25	1+1	rhs	10182648
18	43	100	25	1+1	lhs	10182758
20	28	90	25	1+1	rhs	10182759
20	52	110	25	1+1	rhs	10182760

### Your advantages with *blackline*.

- DP - boring tip for added tool life with grooving and drilling
- Larger DP tip height for more cutting meters and one additional re-grinding cycle
- More rigid tool body already from small diameters of 8 mm, thus very break-proof



## DP shank cutter - *blackline*

Z2, with DP boring tip

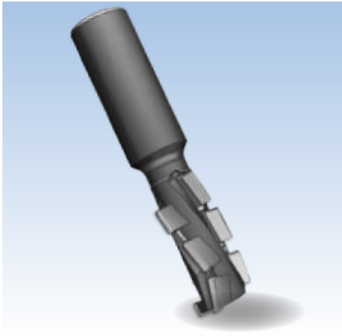

**43020**

**APPLICATION:**

For sizing, grooving, jointing, rebating.  
Very precise shank tolerances, suitable for shrink clamping.

**MATERIAL:**

Panel material with and without coating.  
Thermosetting plastic.

**MACHINE:**

Stationary machines with and without tool changer.

**DESIGN:**

DP knives with axial angle and divided cut;  
shank with internal thread.

**TOOTH:**

DP, tip height 3 mm

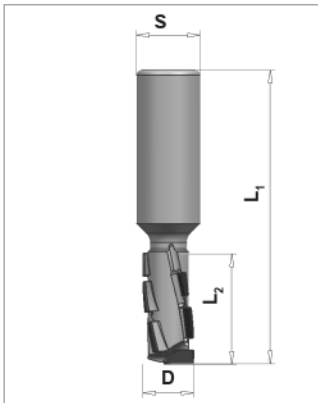

D mm	L2 mm	L1 mm	Shank mm	Z	rhs/lhs	Order No.
16	28	100	25	2+1	rhs	10182761
16	28	100	25	2+1	lhs	10182762
16	34	105	25	2+1	rhs	10182763
16	34	105	25	2+1	lhs	10182764
20	28	100	25	2+1	rhs	10182765
20	28	100	25	2+1	lhs	10182766
20	34	105	25	2+1	rhs	10182767
20	34	105	25	2+1	lhs	10182768
20	43	115	25	2+1	rhs	10182769
20	43	115	25	2+1	lhs	10182770
20	52	125	25	2+1	rhs	10182771
20	52	125	25	2+1	lhs	10182772

### Your advantages with *blackline*.

- DP - boring tip for added tool life with grooving and drilling
- Larger DP tip height for more cutting meters and one additional re-grinding cycle
- More rigid tool body, thus very break-proof

## DP shank cutter Z1 and Z2 Harmony

### Cutting 2.0

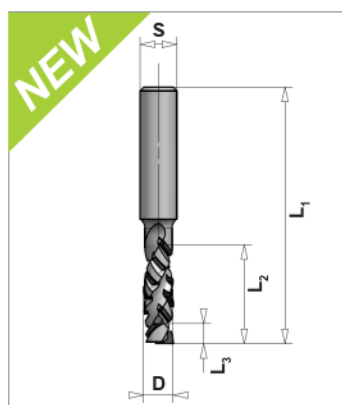

#### APPLICATION:

For sizing, grooving and jointing of wood-based panel material, both with and without coating.  
Especially suitable for chip board with low density and front-end processing of solid wood.  
Very precise shank tolerances; thus suitable for shrink clamping (recommended) suitable for plunge cutting and circular (helix) drilling.

#### MATERIAL:

Panel material with and without coating.

#### MACHINE:

Stationary machines with and without tool changer

#### DESIGN:

Ø 6 - 12,7 mm tool body of solid carbide  
Ø 16 – 25 mm tool body of steel

DP knives with extremely large axial angle with Up-cut and Down-Cut design; for the production of tear-free jointing edges.  
Asymmetrically positioned knives suitable for rabates of up to 5 mm height.

#### TOOTH:

DP  
L3\* = Up-Cut

D mm	L1 mm	L2 mm	L3* mm	Shank mm	rhs/lhs	Z	DT	Order No.
6	64	11	3,6	8	rhs	1	◇	10201796
6	64	15	4,1	8	rhs	1		10201768
6	64	17	4,1	8	rhs	1	◇	10201797
8	70	11	2,5	10	rhs	1	◇	10201767
8	70	17	4,0	10	rhs	1		10201794
8	70	27	4,0	10	rhs	1		10201795
10	80	11	3,7	12	rhs	1	◇	10201765
10	80	17	3,0	12	rhs	1		10201793
10	80	33	4,8	12	rhs	1		10201766
12	80	11	1,8	12	rhs	1	◇	10201761
12	80	17	4,0	12	rhs	1		10201762
12	80	27	4,0	12	rhs	1	◇	10201763
12	80	37	4,0	12	rhs	1		10201764
12	80	11	2,2	12	rhs	2	◇	10201754
12	80	17	2,2	12	rhs	2		10201792
12	80	27	2,2	12	rhs	2	◇	10201755
12	80	37	2,2	12	rhs	2		10201756
12,7	80	11	2,3	12,7	rhs	2	◇	10201757
12,7	80	17	2,2	12,7	rhs	2	◇	10201758
12,7	80	27	2,2	12,7	rhs	2	◇	10201759
12,7	80	37	2,2	12,7	rhs	2	◇	10201760

### Your advantages with Harmony in Cutting 2.0.

- Tear-free edges on the top coating
- No tearing with transverse edge banding
- Ideally suitable for zero joint gaps and laser edge banding technology
- No multiple machining
- Extremely long tool life
- Large variety of materials

# DP shank cutter Z2

## Cutting 2.0

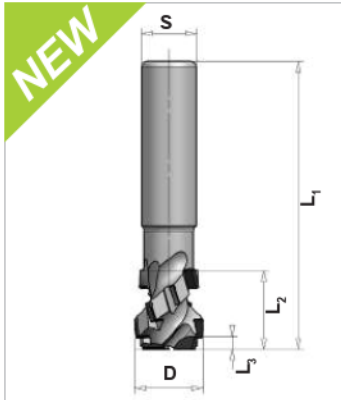

**APPLICATION:**

For sizing, grooving, jointing, rebating.  
Very precise shank tolerances, therefore suitable for shrink clamping (recommended).

**MATERIAL:**

Panel material with and without coating.

**MACHINE:**

Stationary machines with and without tool changer

**DESIGN:**

DP knives with axial angle and divided cut;  
shank 20 and 25 with internal thread.

**TOOTH:**

DP, Ø 20 mm with tip height 4 mm up to 10 times re-sharpenable  
Ø 25 mm with tip height 5 mm up to 14 times re-sharpenable  
L3\* = Up-Cut

D mm	L1 mm	L2 mm	L3* mm	Shank mm	rhs/lhs	th mm	Z	DT	Order No.
16	105	28,7	4,1	20	rhs	4,0	2		10205259
16	105	28,7	4,1	20	lhs	4,0	2	◇	10205260
16	110	34,7	4,1	20	rhs	4,0	2	◇	10205261
16	110	34,7	4,1	20	lhs	4,0	2	◇	10205262
18	105	28,7	4,1	20	rhs	4,0	2		10201721
18	105	28,7	4,1	20	lhs	4,0	2	◇	10201722
18	125	46,7	4,1	20	rhs	4,0	2		10201725
18	125	46,7	4,1	20	lhs	4,0	2	◇	10201726
20	105	28,7	4,1	20	rhs	4,0	2		10201727
20	105	28,7	4,1	20	lhs	4,0	2	◇	10201728
20	110	34,7	4,1	20	rhs	4,0	2	◇	10201729
20	110	34,7	4,1	20	lhs	4,0	2	◇	10201730
20	125	46,7	4,1	20	rhs	4,0	2		10201732
20	125	46,7	4,1	20	lhs	4,0	2	◇	10201733
25	105	28,7	4,1	20	rhs	5,0	2		10201734
25	105	28,7	4,1	20	lhs	5,0	2	◇	10201735
25	125	46,7	4,1	20	rhs	5,0	2		10201736
25	125	46,7	4,1	20	lhs	5,0	2	◇	10201737
16	105	28,7	4,1	25	rhs	4,0	2		10205263
16	105	28,7	4,1	25	lhs	4,0	2	◇	10205264
16	110	34,7	4,1	25	rhs	4,0	2	◇	10205265
16	110	34,7	4,1	25	lhs	4,0	2	◇	10205266
18	105	28,7	4,1	25	rhs	4,0	2		10201723
18	105	28,7	4,1	25	lhs	4,0	2	◇	10201724
18	125	46,7	4,1	25	rhs	4,0	2		10201738
18	125	46,7	4,1	25	lhs	4,0	2	◇	10201739
20	105	28,7	4,1	25	rhs	4,0	2		10201740
20	105	28,7	4,1	25	lhs	4,0	2	◇	10201741
20	110	34,7	4,1	25	rhs	4,0	2		10205257
20	110	34,7	4,1	25	lhs	4,0	2	◇	10205258
20	125	46,7	4,1	25	rhs	4,0	2		10201742
20	125	46,7	4,1	25	lhs	4,0	2	◇	10201743
25	105	28,7	4,1	25	rhs	5,0	2		10201744
25	105	28,7	4,1	25	lhs	5,0	2	◇	10201745
25	110	34,7	4,1	25	rhs	5,0	2		10201746
25	110	34,7	4,1	25	lhs	5,0	2	◇	10201747
25	125	46,7	4,1	25	rhs	5,0	2		10201748
25	125	46,7	4,1	25	lhs	5,0	2	◇	10201749
25	125	52,7	4,1	25	rhs	5,0	2	◇	10201750
25	125	52,7	4,1	25	lhs	5,0	2	◇	10201751

### Now **NEW** Cutting 2.0

Your advantage:

- No multiple machining
- Extremely long tool life
- Large variety of materials

## DP shank cutter Z2

### Cutting 2.0

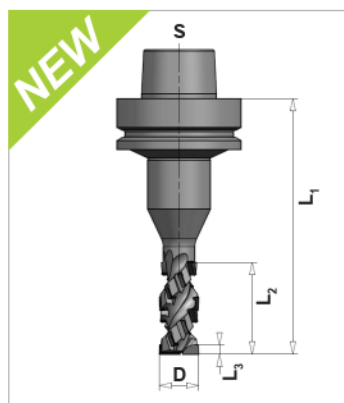

**APPLICATION:**

For sizing, grooving, jointing, rebating.  
Very high concentricity thanks HSK Plus.

**MATERIAL:**

Panel material with and without coating.

**MACHINE:**

Stationary machines with and without tool changer

**DESIGN:**

DP knives with axial angle and divided cut;  
shank 20 and 25 with internal thread.

**TOOTH:**

DP, Ø 20 mm with tip height 4 mm up to 10 times re-sharpenable  
Ø 25 mm with tip height 5 mm up to 14 times re-sharpenable  
L3\* = Up-Cut

D mm	L1 mm	L2 mm	L3* mm	rhs/lhs	Z	DT	Order No. cutter	Order No. with HSK Plus holder 10033898
<b>Tip height 4 mm</b>								
20	80	28,7	4,1	lhs	2	o	10203927	10203941
20	80	28,7	4,1	rhs	2	o	10203926	10203940
20	85	34,7	4,1	lhs	2	o	10203929	10203943
20	85	34,7	4,1	rhs	2	o	10203928	10203942
20	100	46,7	4,1	lhs	2	o	10203931	10203945
20	100	46,7	4,1	rhs	2	o	10203930	10203944
<b>Tip height 5 mm</b>								
25	80	28,7	4,1	lhs	2	o	10203933	10203948
25	80	28,7	4,1	rhs	2	o	10203932	10203947
25	85	34,7	4,1	lhs	2	o	10203935	10203951
25	85	34,7	4,1	rhs	2	o	10203934	10203950
25	100	46,7	4,1	lhs	2	o	10203937	10203953
25	100	46,7	4,1	rhs	2	o	10203936	10203952
25	105	52,7	4,1	lhs	2	o	10203939	10203955
25	105	52,7	4,1	rhs	2	o	10203938	10203954

### Now **NEW** Cutting 2.0

#### Your advantage:

- No multiple machining
- Extremely long tool life
- Large variety of materials

## DP shank - type cutter

Z2, with DP boring tip

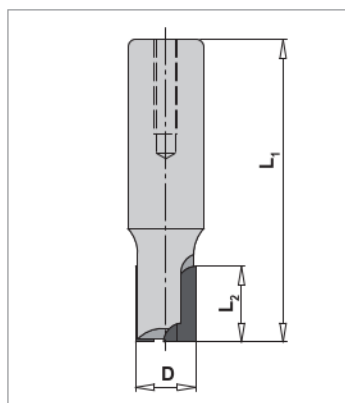

43020

**APPLICATION:**

For sizing, grooving, jointing, rebating

**MATERIAL:**

Flat laminate (e.g. HPL), polymer plastic material (e.g. Corian), MDF

**MACHINE:**

Stationary machines with and without tool changer.

**DESIGN:**

Cutter with alternating axial angle.  
 Particularly recommended for processing laminated material (e.g. HPL). Full-length DP knives and thus a cutting edge without marks as could happen in case of divided knives.

**TOOTH:**

DP, tip height 5 mm, re-grindable up to 14 times

D mm	L2 mm	L1 mm	Shank mm	rhs/lhs	th mm	Z	Order No.
16	20	80	20x50	rhs	5,0	2+1	10110196

## DP shank - type cutter

Z2+2, rh - lh rotation

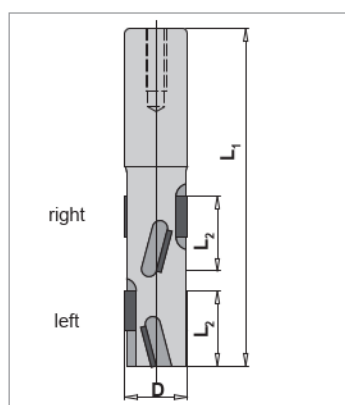

43020

**APPLICATION:**

For sizing and jointing of work top corner joints. Ideal for avoiding damage to visible edges by means of cutting both ways against the rotating direction.

**MATERIAL:**

Panel material with and without coating

**MACHINE:**

Stationary machines with and without tool changer

**DESIGN:**

DP knives with axial angle and positioned over 4 gullets; rh - lh rotation.

**TOOTH:**

DP, tip height 5 mm, re-grindable up to 14 times

D mm	L2 mm	L1 mm	Shank mm	th mm	Z	Order No.
25	30	135	25x55	5,0	2+2	10127176

## DP spiral shank cutter Z3

### Cutting 2.0

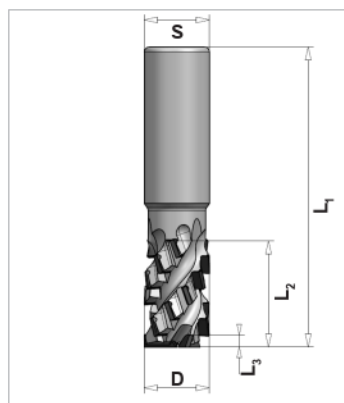

<b>APPLICATION:</b>	For sizing, grooving, jointing, rebating. Very precise shank tolerances; for free plunging and circular drilling (helix); also suitable for shrink clamping.
<b>MATERIAL:</b>	Panel material with and without coating.
<b>MACHINE:</b>	Stationary machines with and without tool changer
<b>DESIGN:</b>	DP knives with axial angle and dividing cut; shank 20 and 25 with internal thread.
<b>TOOTH:</b>	DP, Ø 20 with tip height 4 mm, re-grindable up to 10 times Ø 25 with tip height 5 mm, re-grindable up to 14 times L3* = Up-Cut

D mm	L1 mm	L2 mm	L3* mm	Shank mm	Z	rhs/lhs	DT	Order No.
<b>Tip height 4 mm</b>								
20	105	28,7	4,1	20	3+3	rhs		10190087
20	105	28,7	4,1	20	3+3	lhs	◇	10190089
20	110	34,7	4,1	20	3+3	rhs		10194944
20	110	34,7	4,1	20	3+3	lhs	◇	10194957
20	115	40,7	4,1	20	3+3	rhs		10190090
20	115	40,7	4,1	20	3+3	lhs	◇	10190091
20	125	46,7	4,1	20	3+3	rhs		10190092
20	125	46,7	4,1	20	3+3	lhs	◇	10190093
NEW	20	105	28,7	25	3+3	rhs		10206293
NEW	20	105	28,7	25	3+3	lhs	◇	10206294
NEW	20	110	34,7	25	3+3	rhs		10206295
NEW	20	110	34,7	25	3+3	lhs	◇	10206296
NEW	20	115	40,7	25	3+3	rhs	◇	10206297
NEW	20	115	40,7	25	3+3	lhs	◇	10206298
NEW	20	125	46,7	25	3+3	rhs		10206299
NEW	20	125	46,7	25	3+3	lhs	◇	10206300

### Now **NEW** Cutting 2.0 Your advantage:

- No multiple machining
- Extremely long tool life
- Large variety of materials

Continued next page.

# DP spiral shank cutter Z3

## Cutting 2.0

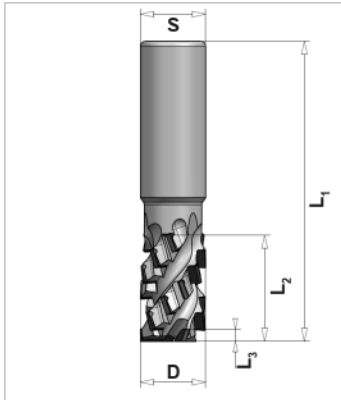

Continued from previous page.

**APPLICATION:**

For sizing, grooving, jointing, rebating.  
Very precise shank tolerances; for free plunging and circular drilling (helix); also suitable for shrink clamping.

**MATERIAL:**

Panel material with and without coating.

**MACHINE:**

Stationary machines with and without tool changer

**DESIGN:**

DP knives with axial angle and dividing cut;  
shank 20 and 25 with internal thread.

**TOOTH:**

DP, Ø 20 with tip height 4 mm, re-grindable up to 10 times  
Ø 25 with tip height 5 mm, re-grindable up to 14 times  
L3\* = Up-Cut

	D mm	L1 mm	L2 mm	L3* mm	Shank mm	Z	rhs/lhs	DT	Order No.
<b>Tip height 5 mm</b>									
NEW	25	105	28,7	4,1	20	3+3	rhs		10206301
NEW	25	105	28,7	4,1	20	3+3	lhs	◇	10206302
NEW	25	110	34,7	4,1	20	3+3	rhs	◇	10206303
NEW	25	110	34,7	4,1	20	3+3	lhs	◇	10206304
NEW	25	115	40,7	4,1	20	3+3	rhs		10206305
NEW	25	115	40,7	4,1	20	3+3	lhs	◇	10206306
NEW	25	125	46,7	4,1	20	3+3	rhs		10206307
NEW	25	125	46,7	4,1	20	3+3	lhs		10206308
NEW	25	125	52,7	4,1	20	3+3	rhs	◇	10206309
NEW	25	125	52,7	4,1	20	3+3	lhs	◇	10206310
NEW	25	135	58,7	4,1	20	3+3	rhs		10206311
NEW	25	135	58,7	4,1	20	3+3	lhs	◇	10206312
NEW	25	145	70,7	4,1	20	3+3	rhs		10206313
NEW	25	145	70,7	4,1	20	3+3	lhs	◇	10206314
	25	105	28,7	4,1	25	3+3	rhs		10190094
	25	105	28,7	4,1	25	3+3	lhs	◇	10190095
	25	110	34,7	4,1	25	3+3	rhs		10194942
	25	110	34,7	4,1	25	3+3	lhs	◇	10194943
	25	115	40,7	4,1	25	3+3	rhs		10190096
	25	115	40,7	4,1	25	3+3	lhs	◇	10190097
	25	125	46,7	4,1	25	3+3	rhs		10190098
	25	125	46,7	4,1	25	3+3	lhs		10190099
	25	125	52,7	4,1	25	3+3	rhs	◇	10190105
	25	125	52,7	4,1	25	3+3	lhs	◇	10190106
	25	135	58,7	4,1	25	3+3	rhs		10190100
	25	135	58,7	4,1	25	3+3	lhs	◇	10190101
	25	145	70,7	4,1	25	3+3	rhs		10190102
	25	145	70,7	4,1	25	3+3	lhs	◇	10190104

## DP spiral shank cutter HSK Plus Z3

### Cutting 2.0

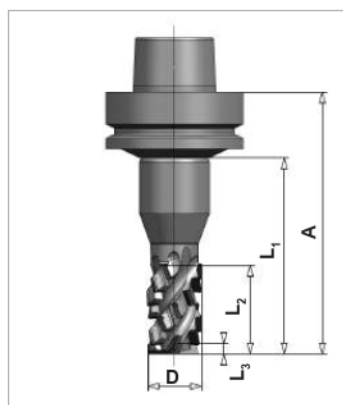

43020

<b>APPLICATION:</b>	For sizing, grooving, jointing, rebating with high feed rates of up to 30 m/min; for free plunging and circular drilling (helix).
<b>MATERIAL:</b>	Panel material with and without coating.
<b>MACHINE:</b>	Stationary machines with and without tool changer
<b>DESIGN:</b>	High rigidity due to HSK Plus interface for high demand. DP knives with axial angle and spiral knife positioning over 3 gullets. Therefore real Z 3 over the complete tip length. Large gullet depth for high hogging performance.
<b>TOOTH:</b>	DP, tip height 5 mm re-grindable up to 14 times L3* = Up-Cut

D mm	L1 mm	L2 mm	L3* mm	A mm	Z	rhs/lhs	DT	Order No. cutter	Order No. with HSK Plus holder 10033898
<b>Tip height 4 mm</b>									
20	80	28,7	4,1	110	3+3	rhs	o	10190138	10190142
20	80	28,7	4,1	110	3+3	lhs	o	10190141	10190145
20	85	34,7	4,1	115	3+3	rhs	o	10194947	10194951
20	85	34,7	4,1	115	3+3	lhs	o	10194948	10194952
20	90	40,7	4,1	120	3+3	rhs	o	10190139	10190143
20	90	40,7	4,1	120	3+3	lhs	o	10194858	10194865
20	100	46,7	4,1	130	3+3	rhs	o	10190140	10190144
20	100	46,7	4,1	130	3+3	lhs		10194859	10194866
<b>Tip height 5 mm</b>									
25	80	28,7	4,1	110	3+3	rhs	o	10190123	10190131
25	80	28,7	4,1	110	3+3	lhs	o	10190122	10190130
25	85	34,7	4,1	115	3+3	rhs	o	10194945	10194949
25	85	34,7	4,1	115	3+3	lhs	o	10194946	10194950
25	90	40,7	4,1	120	3+3	rhs	o	10190125	10190133
25	90	40,7	4,1	120	3+3	lhs	o	10190124	10190132
25	100	46,7	4,1	130	3+3	rhs	o	10190127	10190135
25	100	46,7	4,1	130	3+3	lhs	o	10190126	10190134
25	105	52,7	4,1	135	3+3	rhs	o	10190108	10194863
25	105	52,7	4,1	135	3+3	lhs	o	10190107	10194861
25	110	58,7	4,1	140	3+3	rhs	o	10190129	10190137
25	110	58,7	4,1	140	3+3	lhs	o	10190128	10190136
25	120	70,7	4,1	150	3+3	rhs	o	10194789	10194864
25	120	70,7	4,1	150	3+3	lhs	o	10194790	10194862

### Now **NEW** Cutting 2.0

Your advantage:

- No multiple machining
- Extremely long tool life
- Large variety of materials



## DP shank cutter *Harmony*

With DP boring tip

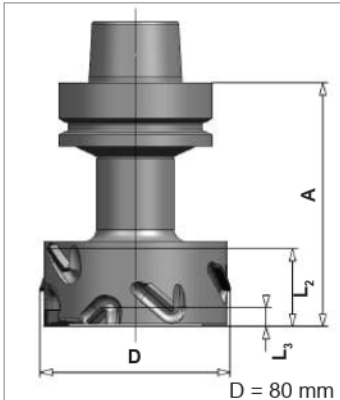

**43020**

**APPLICATION:**

For sizing and jointing of wood-based panels with and without coating. Particularly suitable for chip boards with low density and front-end processing of solid wood.

**MATERIAL:**

Chip board, MDF, Multiplex, hard wood and soft wood, longitudinal and on the face. Wood-based material, honeycomb panels and light constructional panels.

**MACHINE:**

Stationary machines with and without tool changer

**DESIGN:**

Shank cutter with extremely large alternating axial angle for the production of jointing edges without splintering. Ideal for zero joint gaps and laser edge banding technology. The monolithic HSK Plus design guarantees the best possible run-out and thus a consistent, optimal surface quality. Ø 80 mm with V-line gullet.

**TOOTH:**

DP, tip height 3 mm, re-grindable up to 4 times.  
tip height 5 mm, re-grindable up to 14 times.  
L3\* = Up-Cut

**For HSK Plus holder or SK30/40-Plus holder**

D mm	L2 mm	L1 mm	L3* mm	Shank	th mm	Z	max. wood thickness	DT	Order No.
80	30	73	8,3	HSK 63 F	5,0	3+3	27		10190116

**With HSK Plus holder, HSK 63 F**

D mm	L2 mm	L3* mm	A mm	Shank	th mm	Z	max. wood thickness	DT	Order No.
80	30	8,3	100	HSK 63 F	5,0	3+3	27		10190121

### Your advantages with: *Harmony.*

- Tear-free edges on the top coating
- Long service life
- No tearing with transverse edge banding
- For standard and delicate types of material
- Ideally suitable for zero joint gaps and laser edge banding technology
- Particularly suitable for processing of solid wood.

## DP shank cutter Z2 and Z3 Harmony

### Cutting 2.0

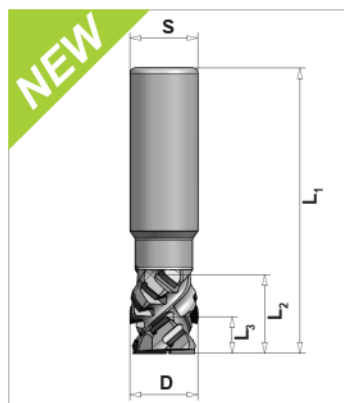

#### APPLICATION:

For sizing, grooving and jointing of wood-based panel material, both with and without coating.  
Especially suitable for chip board with low density and front-end processing of solid wood.  
Very precise shank tolerances; thus suitable for shrink clamping (recommended) suitable for plunge cutting and circular (helix) drilling.

#### MATERIAL:

Panel material with and without coating.

#### MACHINE:

Stationary machines with and without tool changer

#### DESIGN:

Ø 16 - 25 mm tool body of steel

DP knives with extremely large axial angle with Up-cut and Down-Cut design; for the production of tear-free jointing edges.  
Asymmetrically positioned knives suitable for rabates of up to 12 mm height.

#### TOOTH:

DP  
L3\* = Up-Cut

D mm	Shank	L1 mm	L2 mm	L3* mm	Z	rhs/lhs	DT	Order No.
16	25	105	28	11	2	rhs		10206247
16	25	105	34	11	2	rhs		10206248
16	25	120	43	11	2	rhs	◇	10206249
18	20	120	43	11	2	rhs		10206250
18	25	120	43	11	2	rhs	◇	10206251
20	20	105	28	11	2	rhs		10206252
20	20	105	34	11	2	rhs	◇	10206253
20	20	120	43	11	2	rhs		10206254
20	20	120	52	11	2	rhs	◇	10206255
20	25	105	28	11	2	rhs		10206256
20	25	105	34	11	2	rhs	◇	10195138
20	25	120	43	11	2	rhs		10206258
20	25	120	52	11	2	rhs	◇	10196738
25	20	105	28	11	2	rhs		10206260
25	20	105	34	11	2	rhs	◇	10206262
25	20	120	43	11	2	rhs		10206263
25	20	120	52	11	2	rhs		10206264
25	25	105	28	11	2	rhs		10196587
25	25	105	34	11	2	rhs	◇	10206265
25	25	120	43	11	2	rhs		10206266
25	25	120	52	11	2	rhs	◇	10206267
25	20	105	28	11	3	rhs		10206268
25	20	105	34	11	3	rhs	◇	10206269
25	20	120	43	11	3	rhs		10206270
25	20	120	52	11	3	rhs	◇	10206271
25	25	105	28	11	3	rhs		10194725
25	25	105	34	11	3	rhs	◇	10206272
25	25	120	43	11	3	rhs		10206273
25	25	120	52	11	3	rhs	◇	10206274

### Your advantages with **Harmony** in **Cutting 2.0.**

- Tear-free edges on the top coating
- No tearing with transverse edge banding
- Ideally suitable for zero joint gaps and laser edge banding technology
- No multiple machining
- Extremely long tool life
- Large variety of materials

# DP jointing-rebating cutter *Harmony*

## Cutting 2.0

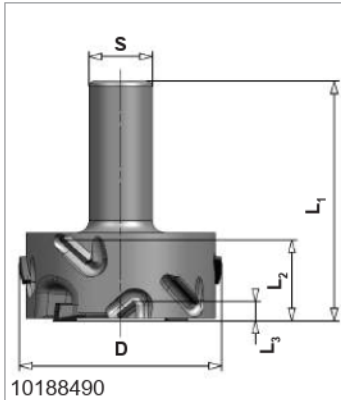

10188490

**43020**

**APPLICATION:**

For rebating and jointing of wooden material and solid wood. Especially suitable for materials with delicate top layers.

**MATERIAL:**

Chip board; MDF; Multiplex; hard wood and soft wood, longitudinal and cross cuts as well as wood-based panels.

**MACHINE:**

Stationary machines with and without tool changer

**DESIGN:**

Jointing – rebating cutter with large alternating axial angle and newly developed rebating knife. With V-line gullet. Almost tear-free rebating and jointing, including cross cuts.

**TOOTH:**

DP, tip height 3 mm, re-grindable up to 4 times.  
L3\* = Up-Cut

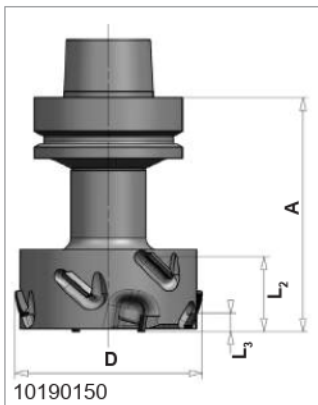

10190150

**DP shank cutter Harmony with cylindrical shank**

D mm	L2 mm	L1 mm	L3* mm	Shank	th mm	Z	DT	Order No.
80	32	95	7,7	25	3,0	2+2	◇	10188490

**DP jointing-rebating cutter Harmony with HSK Plus holder**

D mm	L2 mm	L3* mm	A mm	Shank	th mm	Z	DT	Order No.
80	32	7,7	100	HSK 63 F	3,0	2+2	◇	10190150

**DP jointing-rebating cutter Harmony for HSK Plus holder**

D mm	L2 mm	L3* mm	A mm	Shank	th mm	Z	DT	Order No.
80	32	7,7	70	HSK 63 F	3,0	2+2	◇	10190149

### Your advantages with *Harmony* in **Cutting 2.0**.

- Tear-free edges on the top coating
- No tearing with transverse edge banding
- Ideally suitable for zero joint gaps and laser edge banding technology
- Particularly suitable for processing of solid wood
- No multiple machining
- Extremely long tool life
- No clogging of gullets even with long chips
- Large variety of materials

## DP jointing-rebating cutter *Harmony*

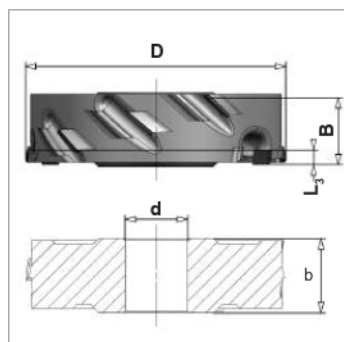

**33020**

<b>APPLICATION:</b>	For rebating and jointing of wooden material and solid wood. Especially suitable for materials with delicate top layers.
<b>MATERIAL:</b>	Chip board, MDF, Multiplex, hard wood and soft wood, longitudinal and cross cuts as well as wood-based panels.
<b>MACHINE:</b>	Bench-type milling machines with manual feed, edge banding machine
<b>DESIGN:</b>	Jointing-rebating cutter with large alternating axial angle and newly developed rebating knife. Special gullets with Streamline-design ensure that the chip removal is trouble-free without multiple chipping – even with materials with big chips. Almost tear-free rebating and jointing, including cross cuts
<b>TOOTH:</b>	DP, tip height 3 mm, re-grindable up to 4 times L3* = Up-Cut

D mm	B mm	b mm	d mm	L3* mm	Z	th mm	rhs/lhs	DT	Order No.
125	32	35,5	30	7,1	2+2	3,0	rhs		10181618
150	32	35,5	50	7,1	2+2	3,0	rhs	◇	10188529
150	50	53,5	30	7,1	2+2	3,0	rhs	◇	10189503
150	50	53,5	50	7,1	2+2	3,0	rhs	◇	10190752

### Your advantages with *Harmony*.

- Processing a huge variety of materials in joineries
- Improved surface quality compared to TOK systems
- Favourable purchase price and low service cost
- Jointing knives for perfect edges, both at the beginning and the end
- 2 additional rebating knives for tear-free, smooth rebates
- No fraying when cutting against the glued edge

## DP Nesting cutter

With DP boring tip

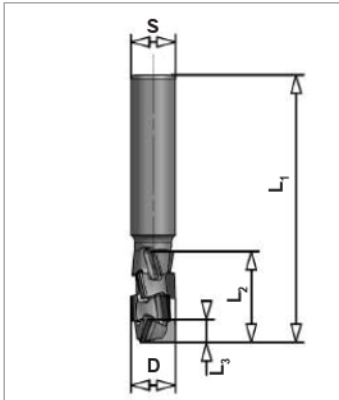

**43020**

<b>APPLICATION:</b>	High performance shank cutter for Nesting application
<b>MATERIAL:</b>	Chip board, MDF, Multiplex wood-based panel material with and without coating.
<b>MACHINE:</b>	Stationary machine
<b>DESIGN:</b>	With extremely rigid tool body made of heavy duty steel. With alternating axial angle and gullets for optimal chip ejection. Suitable for high cutting performance. Feed rates depending on the material and diameter up to 30 m/min.
<b>TOOTH:</b>	DP, tip height 2,5 mm, re-grindable up to 3 times L3* = Up-Cut

D mm	L2 mm	L1 mm	L3* mm	Shank mm	th mm	Z	Order No.
12	24,5	69	8,2	12	2,5	3	10170464
16	24,5	77	8,2	16	2,5	3	10173288

### For HSK Plus holder, HSK 63 F

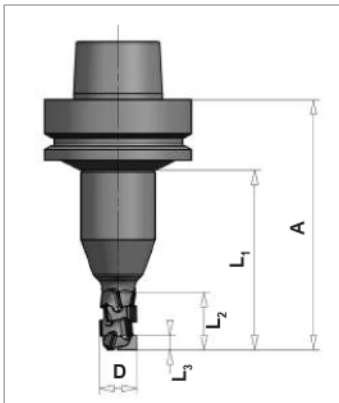

D mm	L2 mm	L1 mm	L3* mm	A mm	th mm	Z	Order No.
16	24,5	77	6,2	107	2,5	3	10174356

### With HSK Plus holder, HSK 63 F

D mm	L2 mm	L3* mm	A mm	th mm	Z	Order No.
16	24,5	6,2	107	2,5	3	10174368

## Your advantages with **AKE Nesting.**

- No tool breach due to high-performance steel
- Increased feed speed
- Higher economic efficiency
- Longer service life

# DP jointing cutter

## Cutting 2.0

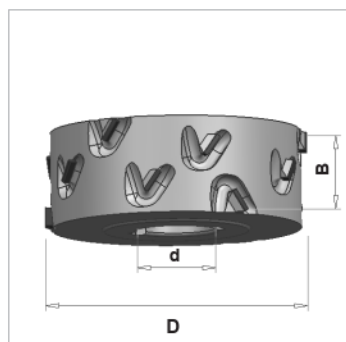

**33020**

saw body type with fig. of hub length



Type A



Type B



Type C

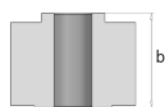

Type D

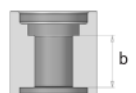

Type E

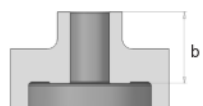

Type F

**APPLICATION:**

For sizing and jointing of wood-based panel material with and without coating. Limited suitability for chip boards with low density and front-end processing of solid wood.

**MATERIAL:**

Chip board, MDF, Multiplex, hard wood and soft wood longitudinal, wood-based panel material.

**MACHINE:**

Edge banding machines

**DESIGN:**

Jointing cutter with alternating axial angle for sizing and the production of tear-free jointing edges; with V-line gullet. Design optionally symmetrical or asymmetrical.

**TOOTH:**

DP, tip height 3 mm, re-grindable up to 4 times  
tip height 5 mm, re-grindable up to 14 times

**SYMMETRICAL DESIGN:**

Always adjusted to the centre of the workpiece. The tool is slightly convex at the outer diameter. For both right hand and left hand rotation.

**ASYMMETRICAL DESIGN:**

Always adjusted to the bottom line of the workpiece. The tool is straight at the outer diameter, right hand or left hand design.

D mm	B mm	b mm	d mm	Z	th mm	Machine	Type	rhs/lhs	DT	Order No.
60	64	64	25/DKN	2+2	3,0	Felder	C	rhs	◇	10189632
60	64	64	25/DKN	2+2	3,0	Felder	C	lhs	◇	10189633
70	47	61	25/DKN	2+2	3,0	Hebrock	D	rhs		10189652
70	47	61	25/DKN	2+2	3,0	Hebrock	D	lhs		10189653
70	54	31	30/DKN	2+2	3,0	HolzHer	E	rhs	◇	10189639
70	54	31	30/DKN	2+2	3,0	HolzHer	E	lhs	◇	10189640
70	64	41	30/DKN	2+2	3,0	HolzHer	E	rhs		10189641
70	64	41	30/DKN	2+2	3,0	HolzHer	E	lhs		10189642
85	45	48	30/DKN	3+3	3,0	Ott	A	rhs		10189607
85	45	48	30/DKN	3+3	3,0	Ott	A	lhs		10189608
100	34	39	30/DKN	3+3	3,0	Brandt	A	rhs	◇	10189609
100	34	39	30/DKN	3+3	3,0	Brandt	A	lhs	◇	10189612
100	45,5	61	30/DKN	2+2	3,0	Hebrock	D	rhs		10189630
100	45,5	61	30/DKN	2+2	3,0	Hebrock	D	lhs		10189631
100	48	25	30/DKN	2+2	3,0	HolzHer	C	rhs		10189620
100	48	25	30/DKN	2+2	3,0	HolzHer	C	lhs		10189621
100	48	40,6	25/DKN	2+2	3,0	Brandt	B	rhs	◇	10190580
100	48	40,6	25/DKN	2+2	3,0	Brandt	B	lhs	◇	10190581
100	48	40,6	30/DKN	3+3	3,0	Brandt	B	rhs		10189618
100	48	40,6	30/DKN	3+3	3,0	Brandt	B	lhs		10189619
100	63	25	30/DKN	2+2	3,0	HolzHer	C	rhs	◇	10189643
100	63	25	30/DKN	2+2	3,0	HolzHer	C	lhs	◇	10189644
100	63	40,6	30/DKN	3+3	3,0	IMA/Brandt	B	rhs	◇	10198322
100	63	40,6	30/DKN	3+3	3,0	IMA/Brandt	B	lhs	◇	10198323
100	65,5	75	30/DKN	2+2	3,0	Hebrock	D	rhs	◇	10189637
100	65,5	75	30/DKN	2+2	3,0	Hebrock	D	lhs	◇	10189638

Continued next page.

# DP jointing cutter

## Cutting 2.0

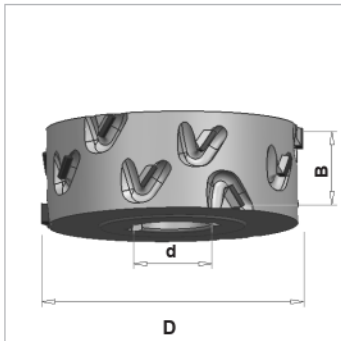

Continued from previous page.

**33020**

saw body type with fig. of hub length



Type A



Type B

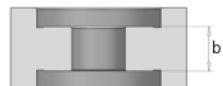

Type C

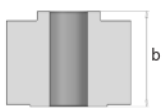

Type D

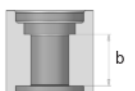

Type E

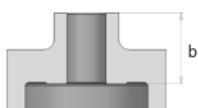

Type F

**APPLICATION:**

For sizing and jointing of wood-based panel material with and without coating. Limited suitability for chip boards with low density and front-end processing of solid wood.

**MATERIAL:**

Chip board, MDF, Multiplex, hard wood and soft wood longitudinal, wood-based panel material.

**MACHINE:**

Edge banding machines

**DESIGN:**

Jointing cutter with alternating axial angle for sizing and the production of tear-free jointing edges; with V-line gullet. Design optionally symmetrical or asymmetrical.

**TOOTH:**

DP, tip height 3 mm, re-grindable up to 4 times  
tip height 5 mm, re-grindable up to 14 times

**SYMMETRICAL DESIGN:**

Always adjusted to the centre of the workpiece. The tool is slightly convex at the outer diameter. For both right hand and left hand rotation.

**ASYMMETRICAL DESIGN:**

Always adjusted to the bottom line of the workpiece. The tool is straight at the outer diameter, right hand or left hand design.

D mm	B mm	b mm	d mm	Z	th mm	Machine	Type	rhs/lhs	DT	Order No.
125	34	37,6	30/DKN	3+3	3,0	Homag	C	sym		10189662
125	42	47	30/DKN	3+3	3,0	Biesse	A	sym	◇	10189664
125	43	40	30/DKN	3+3	3,0	Homag	C	sym		10189663
125	43	57	30/DKN	3+3	3,0	IMA Advantage	F	rhs		10190607
125	43	57	30/DKN	3+3	3,0	IMA Advantage	F	lhs		10190608
125	48	40,6	30/DKN	3+3	3,0	IMA	B	rhs		10189650
125	48	40,6	30/DKN	3+3	3,0	IMA	B	lhs		10189651
125	63	40,6	30/DKN	3+3	3,0	IMA	B	rhs	◇	10189648
125	63	40,6	30/DKN	3+3	3,0	IMA	B	lhs	◇	10189649
125	63	40,6	30/DKN	3+3	3,0	Homag	C	sym		10189660
125	63	57	30/DKN	3+3	3,0	IMA Advantage	F	rhs	◇	10190605
125	63	57	30/DKN	3+3	3,0	IMA Advantage	F	lhs	◇	10190606
<b>Tip height 5 mm</b>										
100	45,5	61	30/DKN	2+2	5,0	Hebrock	D	rhs	◇	10189656
100	45,5	61	30/DKN	2+2	5,0	Hebrock	D	lhs	◇	10189657
100	48	25	30/DKN	2+2	5,0	HolzHer	C	rhs	◇	10190794
100	48	25	30/DKN	2+2	5,0	HolzHer	C	lhs	◇	10190795
100	48	40,6	30/DKN	3+3	5,0	Brandt	B	rhs		10189654
100	48	40,6	30/DKN	3+3	5,0	Brandt	B	lhs		10189655
100	65,5	75	30/DKN	2+2	5,0	Hebrock	D	rhs	◇	10189658
100	65,5	75	30/DKN	2+2	5,0	Hebrock	D	lhs	◇	10189659

### Now **NEW** Cutting 2.0

Your advantage:

- No multiple machining
- Extremely long tool life
- No clogging of gullets even with long chips
- Large variety of materials

# DP jointing cutter *Harmony*

## Cutting 2.0

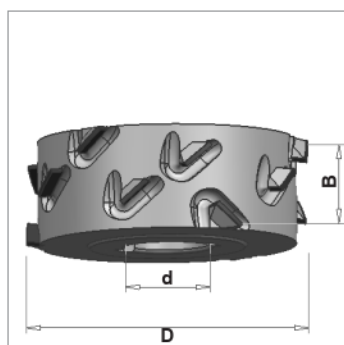

**33020**

**APPLICATION:**

For sizing and jointing of wood-based panel material with and without coating. Particularly suitable for chip boards with low density and front-end processing of solid wood.

**MATERIAL:**

Chip board; MDF; Multiplex; hard wood and soft wood, longitudinally and on the face. Wood-based panel material.

**MACHINE:**

Edge banding machine

**DESIGN:**

Jointing cutter with extremely large alternating axial angle for sizing and for the production of clean jointing edges. With V-line gullet. Ideal for zero joint gap and laser edge banding technology.

**TOOTH:**

DP, tip height 5 mm, re-grindable up to 14 times

**SYMMETRICAL DESIGN:**

Always adjusted to the centre of the workpiece. The tool is slightly convex at the outer diameter. For both right hand and left hand rotation.

**ASYMMETRICAL DESIGN:**

Always adjusted to the bottom line of the workpiece. The tool is straight at the outer diameter, right hand or left hand design.

saw body type with fig. of hub length



Type A



Type B



Type C



Type D

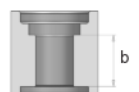

Type E

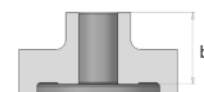

Type F

D mm	B mm	b mm	d mm	Z	th mm	Machine	Type	rhs/lhs	DT	Order No.
60	64	64	25/DKN	2+2	5,0	Felder	C	rhs	◇	10189678
60	64	64	25/DKN	2+2	5,0	Felder	C	lhs	◇	10189679
70	47	61	25/DKN	2+2	5,0	Hebrock	D	rhs	◇	10189700
70	47	61	25/DKN	2+2	5,0	Hebrock	D	lhs	◇	10189701
70	54	31	30/DKN	2+2	5,0	HolzHer	E	rhs	◇	10189682
70	54	31	30/DKN	2+2	5,0	HolzHer	E	lhs	◇	10189683
70	64	41	30/DKN	2+2	5,0	HolzHer	E	rhs	◇	10189684
70	64	41	30/DKN	2+2	5,0	HolzHer	E	lhs	◇	10189685
85	45	48	30/DKN	3+3	5,0	Ott	A	rhs	◇	10189666
85	45	48	30/DKN	3+3	5,0	Ott	A	lhs	◇	10189667
100	34	39	30/DKN	3+3	5,0	Brandt	A	rhs		10189669
100	34	39	30/DKN	3+3	5,0	Brandt	A	lhs		10189668
100	45,5	61	30/DKN	2+2	5,0	Hebrock	D	rhs	◇	10189674
100	45,5	61	30/DKN	2+2	5,0	Hebrock	D	lhs	◇	10189675
100	48	25	30/DKN	2+2	5,0	HolzHer	C	rhs	◇	10189672
100	48	25	30/DKN	2+2	5,0	HolzHer	C	lhs	◇	10189673
100	48	40,6	25/DKN	2+2	5,0	Brandt	B	rhs	◇	10190484
100	48	40,6	25/DKN	2+2	5,0	Brandt	B	lhs	◇	10190485
100	48	40,6	30/DKN	3+3	5,0	Brandt	B	rhs		10189671
100	48	40,6	30/DKN	3+3	5,0	Brandt	B	lhs		10189670
100	63	25	30/DKN	2+2	5,0	HolzHer	C	rhs	◇	10189687
100	63	25	30/DKN	2+2	5,0	HolzHer	C	lhs	◇	10189686
100	63	40,6	30/DKN	3+3	5,0	IMA/Brandt	B	rhs		10190084
100	63	40,6	30/DKN	3+3	5,0	IMA/Brandt	B	lhs		10190085
100	65,5	75	30/DKN	2+2	5,0	Hebrock	D	rhs	◇	10189676
100	65,5	75	30/DKN	2+2	5,0	Hebrock	D	lhs	◇	10189677

Continued next page.



# DP jointing cutter *Harmony*

## Cutting 2.0

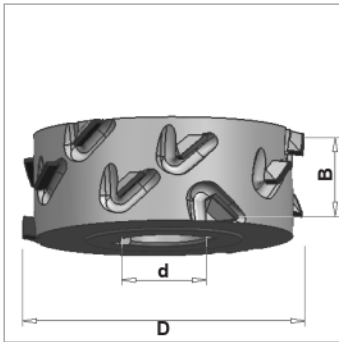

Continued from previous page.

**33020**

saw body type with fig. of hub length



Type A

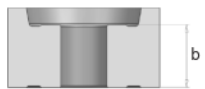

Type B

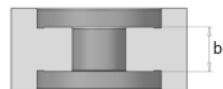

Type C

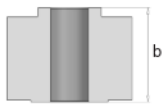

Type D

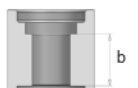

Type E

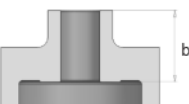

Type F

**APPLICATION:**

For sizing and jointing of wood-based panel material with and without coating. Particularly suitable for chip boards with low density and front-end processing of solid wood.

**MATERIAL:**

Chip board; MDF; Multiplex; hard wood and soft wood, longitudinally and on the face. Wood-based panel material.

**MACHINE:**

Edge banding machine

**DESIGN:**

Jointing cutter with extremely large alternating axial angle for sizing and for the production of clean jointing edges. With V-line gullet. Ideal for zero joint gap and laser edge banding technology.

**TOOTH:**

DP, tip height 5 mm, re-grindable up to 14 times

**SYMMETRICAL DESIGN:**

Always adjusted to the centre of the workpiece. The tool is slightly convex at the outer diameter. For both right hand and left hand rotation.

**ASYMMETRICAL DESIGN:**

Always adjusted to the bottom line of the workpiece. The tool is straight at the outer diameter, right hand or left hand design.

D mm	B mm	b mm	d mm	Z	th mm	Machine	Type	rhs/ lhs	DT	Order No.
125	34	37,6	30/DKN	3+3	5,0	Homag	C	sym		10189690
125	42	47	30/DKN	3+3	5,0	Biesse	A	sym	◇	10189699
125	43	40	30/DKN	3+3	5,0	Homag	C	sym		10189698
125	43	57	30/DKN	3+3	5,0	IMA Advantage	F	rhs	◇	10190745
125	43	57	30/DKN	3+3	5,0	IMA Advantage	F	lhs	◇	10190746
125	48	40,6	30/DKN	3+3	5,0	IMA	B	rhs		10189697
125	48	40,6	30/DKN	3+3	5,0	IMA	B	lhs		10189693
125	63	40,6	30/DKN	3+3	5,0	Homag	C	sym	◇	10189688
125	63	40,6	30/DKN	3+3	5,0	IMA	B	rhs	◇	10189691
125	63	40,6	30/DKN	3+3	5,0	IMA	B	lhs	◇	10189692
125	63	57	30/DKN	3+3	5,0	IMA Advantage	F	rhs	◇	10190743
125	63	57	30/DKN	3+3	5,0	IMA Advantage	F	lhs	◇	10190744

### Your advantages with *Harmony* in **Cutting 2.0.**

- Tear-free edges on the top coating
- No tearing with transverse edge banding
- Ideally suitable for zero joint gaps and laser edge banding technology
- Particularly suitable for processing of solid wood
- No multiple machining
- Extremely long tool life
- No clogging of gullets even with long chips
- Large variety of materials

## DP radii trimming cutter *Streamline*

With axial angle

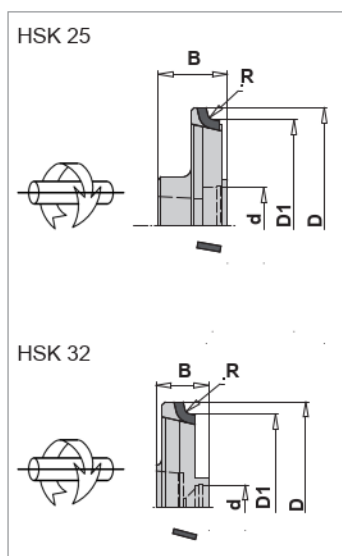

**35020**

**APPLICATION:** For smoothing and profiling of edges on keyed aggregates

**MATERIAL:** All types of edge banding material.  
PVC, PP, ABS, melamine, veneer, solid wood.

**MACHINE:** Sizing machines and edge banding machines

**DESIGN:** Radii cutters with HSK25/HSK32 holder and clamp screw.  
This tool has a small axial angle in order to protect the edge against being pulled down. Chip guided design.

**TOOTH:** DP

D mm	D1- basic diameter	B mm	d mm	Z	th mm	R	n (max) min <sup>-1</sup>	rhs/ lhs	DT	Order No.
79	70	23	HSK 25	4	2,5	1,5	24.000	rhs	◇	10176500
79	70	23	HSK 25	4	2,5	1,5	24.000	lhs	◇	10176501
79	70	23	HSK 25	6	2,5	1,5	24.000	rhs	◇	10176502
79	70	23	HSK 25	6	2,5	1,5	24.000	lhs	◇	10176503
79	70	23	HSK 25	4	2,5	2	24.000	rhs	◇	10176505
79	70	23	HSK 25	4	2,5	2	24.000	lhs	◇	10176506
79	70	23	HSK 25	6	2,5	2	24.000	rhs	◇	10176507
79	70	23	HSK 25	6	2,5	2	24.000	lhs	◇	10176508
79	70	23	HSK 25	4	2,5	3	24.000	rhs	◇	10176509
79	70	23	HSK 25	4	2,5	3	24.000	lhs	◇	10176510
79	70	23	HSK 25	6	2,5	3	24.000	rhs	◇	10176511
79	70	23	HSK 25	6	2,5	3	24.000	lhs	◇	10176512

D mm	D1- basic diameter	B mm	d mm	Z	th mm	R	n (max) min <sup>-1</sup>	rhs/ lhs	DT	Order No.
70	62	17,5	HSK 32	4	2,5	1,5	24.000	rhs	◇	10176513
70	62	17,5	HSK 32	4	2,5	1,5	24.000	lhs	◇	10176514
70	62	17,5	HSK 32	6	2,5	1,5	24.000	rhs	◇	10176515
70	62	17,5	HSK 32	6	2,5	1,5	24.000	lhs	◇	10176517
70	62	17,5	HSK 32	4	2,5	2	24.000	rhs	◇	10176518
70	62	17,5	HSK 32	4	2,5	2	24.000	lhs	◇	10176519
70	62	17,5	HSK 32	6	2,5	2	24.000	rhs	◇	10176520
70	62	17,5	HSK 32	6	2,5	2	24.000	lhs	◇	10176521
70	62	17,5	HSK 32	4	2,5	3	24.000	rhs	◇	10176522
70	62	17,5	HSK 32	4	2,5	3	24.000	lhs	◇	10176523
70	62	17,5	HSK 32	6	2,5	3	24.000	rhs	◇	10176525
70	62	17,5	HSK 32	6	2,5	3	24.000	lhs	◇	10176526

**RE-GRINDING AREA:** Tip height 2,5 mm.  
Can be re-sharpened.  
However, re-grinding is not recommended, because the rollers have to be adjusted to the new, smaller tool diameter after sharpening with high expenditure of time.

# DP multiple radii trimming cutter

For through-feed machines

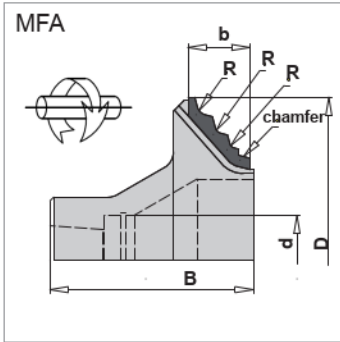

**35020**

**APPLICATION:** For smoothing and profiling of edges on keyed aggregates

**MATERIAL:** All types of edge banding material.  
PVC, PP, ABS, melamine, veneer, solid wood

**MACHINE:** IMA sizing machines and edge banding machines.  
KFA and MFA aggregate.

**DESIGN:** MFA = cranked cutter, horizontal spindle.  
KFA = straight cutter, swivelled spindle.  
radii cutter with multiple radii and chamfer.  
Radii are designed according to customer demand.

**TOOTH:** DP

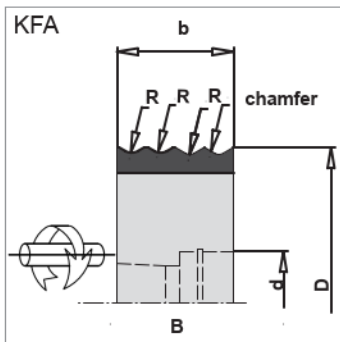

KFA cutter available on demand

### MFA cutter

D mm	B mm	b mm	d mm	Z	th mm	R	chamfer	n (max) min <sup>-1</sup>	rhs/lhs	DT	Order No.
90	56	17	HSK 25	6	2,5	1,0/2,0/3,0	15°	24.000	rhs	o	10029541
90	56	17	HSK 25	6	2,5	1,0/2,0/3,0	15°	24.000	lhs	o	10029540
90	56	17	HSK 25	6	2,5	2,0/3,0	20°	24.000	rhs	o	10039580
90	56	17	HSK 25	6	2,5	2,0/3,0	20°	24.000	lhs	o	10039581

**RE-GRINDING AREA:** Tip height 3 mm.  
Can be re-sharpened.  
However, re-grinding is not recommended, because the rollers have to be adjusted to the new, smaller tool diameter after sharpening with high expenditure of time.

## DP bevel cutter *Streamline*

With axial angle

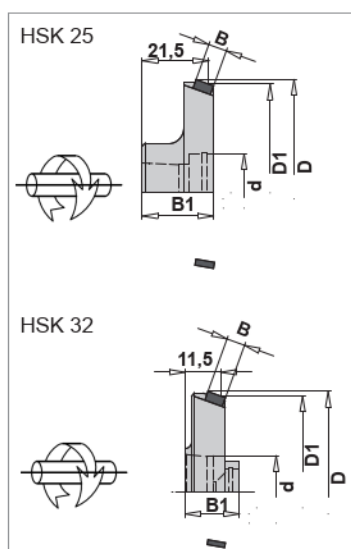

**35020**

<b>APPLICATION:</b>	For bevelling
<b>MATERIAL:</b>	Solid wood, veneer, PVC, PP, ABS, PMMA, HPL, melamine, solid melamine
<b>MACHINE:</b>	IMA, Homag edge banding machines
<b>DESIGN:</b>	Bevel cutters with HSK25/HSK32 holder and clamp screw. This tool has a small axial angle in order to protect the edge against being pulled down. Chip guided design.
<b>TOOTH:</b>	DP

D mm	D1-basic diameter	B mm	B1 mm	d mm	Z	th mm	cham-fer	n (max) min <sup>-1</sup>	rhs/lhs	DT	Order No.
74	70	6	23	HSK 25	4	3	20°	24.000	rhs	◇	10176531
74	70	6	23	HSK 25	4	3	20°	24.000	lhs	◇	10176532
74	70	6	23	HSK 25	6	3	20°	24.000	rhs	○	10176533
74	70	6	23	HSK 25	6	3	20°	24.000	lhs	○	10176534

D mm	D1-basic diameter	B mm	B1 mm	d mm	Z	th mm	cham-fer	n (max) min <sup>-1</sup>	rhs/lhs	DT	Order No.
65	62	6	17,5	HSK 32	4	3	20°	24.000	rhs	◇	10176535
65	62	6	17,5	HSK 32	4	3	20°	24.000	lhs	◇	10176536
65	62	6	17,5	HSK 32	6	3	20°	24.000	rhs	○	10176537
65	62	6	17,5	HSK 32	6	3	20°	24.000	lhs	○	10176538

**RE-GRINDING AREA:** Tip height 3 mm.  
Can be re-sharpened.  
However, re-grinding is not recommended, because the rollers have to be adjusted to the new, smaller tool diameter after sharpening with high expenditure of time.

## DP trimming cutter *Streamline*

With axial angle

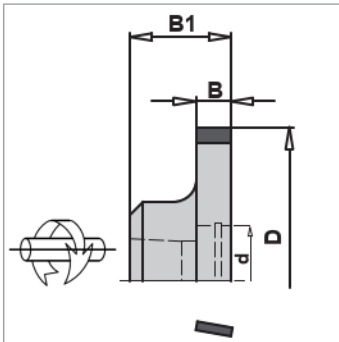

**35020**

<b>APPLICATION:</b>	For smoothing edges on keyed aggregates
<b>MATERIAL:</b>	All types of edge banding material. PVC, PP, ABS, melamine, veneer
<b>MACHINE:</b>	Sizing machines and edge banding machines
<b>DESIGN:</b>	Trimming cutter with HSK 25 holder and clamp screw. This tool has a small axial angle in order to protect the edge against being pulled down. Chip guided design.
<b>TOOTH:</b>	DP

D mm	B mm	B1 mm	d mm	Z	th mm	n (max) min <sup>-1</sup>	rhs/lhs	DT	Order No.
70	8	23	HSK 25	4	3	24.000	rhs	◇	10176539
70	8	23	HSK 25	4	3	24.000	lhs	◇	10176540
70	8	23	HSK 25	6	3	24.000	rhs	○	10176542
70	8	23	HSK 25	6	3	24.000	lhs	○	10176541

**RE-GRINDING AREA:** Tip height 3 mm.  
Can be re-sharpened.  
However, re-grinding is not recommended, because the rollers have to be adjusted to the new, smaller tool diameter after sharpening with high expenditure of time.

## DP compact hogger Ultra Streamline



2600

<b>APPLICATION:</b>	For sizing wood-based panel material with and without coating
<b>MATERIAL:</b>	Chip board, MDF, Multiplex, hard wood and soft wood longitudinal, wood-based panel material. Suitable also for chip boards with low density.
<b>MACHINE:</b>	Sizing machines and edge banding machines
<b>DESIGN:</b>	With chip guidance for sizing and for the production of tear-free narrow surface edges and workpiece edges. ULTRA design (no reduction of the cutting width when re-grinding) The hogger can be re-eroded on top and side removing the same amount.
<b>TOOTH:</b>	DP, Tip height 6 mm Re-eroding up to 12 times

D mm	B mm	Z	rhs/lhs	DT	for S-System 160	for S-System 192	Hogger with sleeve	Hogger with hydro sleeve
					Order No.	Order No.	Order No.	Order No.
250	10	54	lhs	o	10174929	10171497	10171508	10171516
250	10	54	rhs	o	10174930	10171496	10171507	10171515
250	10	48	lhs	o	10174931	10171495	10171506	10171514
250	10	48	rhs	o	10174932	10171494	10171505	10171513
250	10	36	lhs	o	10174933	10171493	10171504	10171512
250	10	36	rhs	o	10174934	10171492	10171503	10171511
250	10	24	lhs	o	10174935	10171491	10171502	10171510
250	10	24	rhs	o	10174937	10171489	10171501	10171509

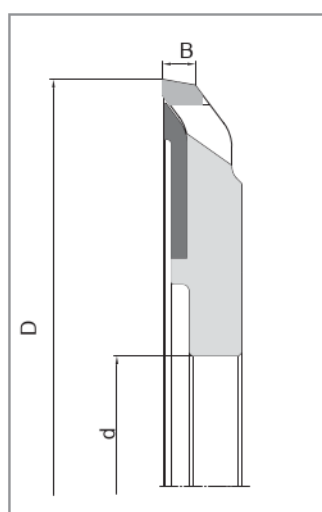

<b>INTERFACE:</b>	Quick clamping sleeve 160 with 4 bayonet holders, TK 130 hogger d = 60 mm Quick clamping sleeve 192 with 4 bayonet holders, TK 150 hogger d = 80 mm Standard hogger sleeve d = 35 mm DKW (Homag / IMA) Hydro sleeve d = 40 mm hexagonal
-------------------	--

<b>FEED SPEED:</b>	Z 24      feed up to 30 m/min Z 36      feed up to 36 bis 45 m/min Z 48      feed up to 48 bis 60 m/min Z 54      feed up to 54 bis 70 m/min Hoggers for higher feed speed on demand.
--------------------	---

### Your advantages with Ultra Streamline.

- Chip guiding function by means of a chip disc.
- Chip ejection away from the material right into the suction.
- No re-hogging, almost dust-free workpiece surfaces.

